

FORM OF SHORT TENDER NOTICE

D2/8601/21/GECTCR

Government Engineering College Thrissur

Sealed tenders are invited for **fabrication of loading frame and testing tank** for Civil Engineering Department

Approximate cost Rs 3,00,000/-

Specification separately attached

The envelopes containing the tender should bear the superscription "Tender. No. **D2/24/21-22 due on 13/12/2021** and should be addressed to the Principal, Government. Engineering. College, Thrissur, Kerala..

Last date for receipt of tenders will be **13/12/2021 2.00 pm** Late tenders will not be accepted. The tenders will be opened at Government Engineering College Thrissur on **14/12/2021 3.00 PM** in the presence of such of the tenderers or their authorized representatives who may be present at that time. Intending tenderers may, on application to the Principal, Govt. Engineering. College, Thrissur, obtain the requisite tender forms on which tenders should be submitted. Application for the tender form should be accompanied by a cash remittance of **Rs.708/- (600+18%GST) + postal charge** which is the price fixed for a form/set of forms and which is not refundable under any circumstances. The tender forms are not transferable. Sale of tender forms will be closed at **12 pm on 13/12/2021** Cheques, postage stamps, etc., will not be accepted towards the cost of forms, nor will the forms be sent per V.P.P.

Tenders should be accompanied by EMD of 1%, subject to a minimum of Rs. 1500/- , of the amount by DD drawn in favour of the Principal, Government.Engineering College, Thrissur with an agreement in Kerala Stamp Paper worth Rs.220/-. Details can be had from the Govt.Engineering College Office working hours.

Place:Thrissur

Bhattathripad

22.11.2021

Principal

Copy to

1. Notice Board
2. HOD,Civil Engineering

Dr.Ranjini

PRINCIPAL
GOVT ENGG. COLLEGE
THRISSUR

etc

Item Description

| SL No | Name of item and specification | Quantity |
|-------|---|----------|
| 1 | <p>Fabrication, erection and commissioning of loading frame of capacity 50t using ISMB 300 and ISMC 300 sections consisting of two vertical posts and horizontal member for fixing hydraulic jack as per the attached drawing. The height of frame shall be a 2.5m with provision for fixing hydraulic jacks at 1.5m, 2m and 2.5m from the platform, including supply of tank of size 1mx1mx1m using steel plate of 4mm thickness and necessary stiffeners, including painting with primer and two finishing coats etc complete. Include fixing the loading to found.</p> <p>Provision of footing of size 2.1 X 2.65 M platform by ISMC 300. Loading frame shall be connected to the platform using required anchor bolts of adequate capacity.</p> | 1 |

PRINCIPAL
GOVT ENGG. COLLEGE
THRISSUR.

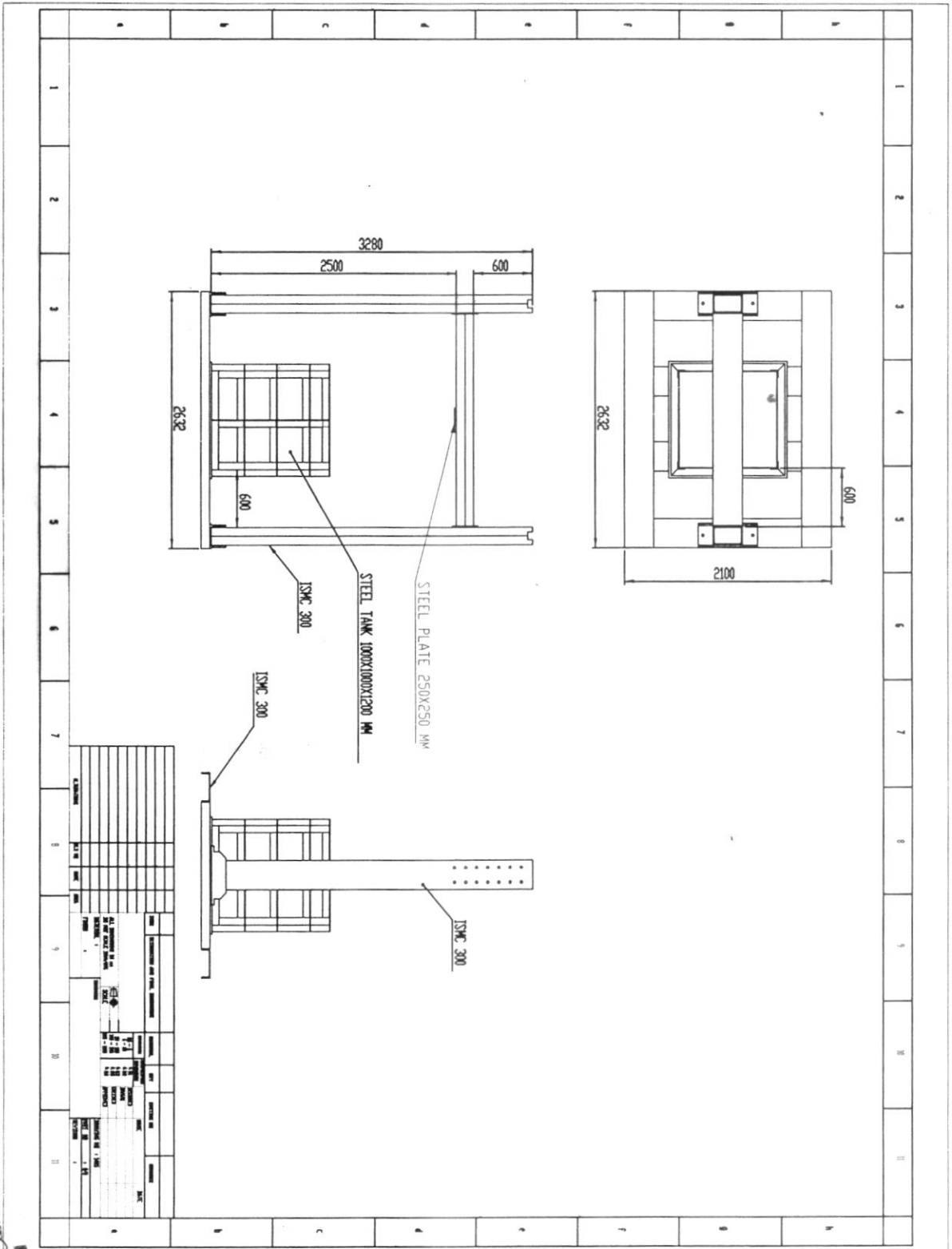

| NO. | REVISIONS AND DATE | BY | CHKD. | DATE |
|-----|--------------------|----|-------|------|
| 1 | ISSUED FOR TENDER | | | |
| 2 | ISSUED FOR WORK | | | |
| 3 | ISSUED FOR WORK | | | |
| 4 | ISSUED FOR WORK | | | |
| 5 | ISSUED FOR WORK | | | |
| 6 | ISSUED FOR WORK | | | |
| 7 | ISSUED FOR WORK | | | |
| 8 | ISSUED FOR WORK | | | |
| 9 | ISSUED FOR WORK | | | |
| 10 | ISSUED FOR WORK | | | |
| 11 | ISSUED FOR WORK | | | |

W.M.
 PRINCIPAL
 GOVT. ENGINEERING COLLEGE
 THIRISSUR.